

REV 'A' ITEM NO. WAS '19050100' BY:DR. 7-13-98 CK:W.T.
 REV 'B' DELETE ITEM NO. FOR MILD STEEL BY:DR. 7-13-98 CK:W.T.
 REV 'C' ITEM NO. WAS '20340010' BY:DR. 7-13-98 CK:W.T.
 REV 'D' DIM ADDED BY:DR. 7-13-98 CK:W.T.

TANK WALL INSIDE
 NOTE: TANK WALL CONFIGURATION MAY VARY--SEE TANK DWG.

RING 3" SPLIT BACK-UP TAPERED (SEE DTL.)

NOTE: BOLT HOLES TO STRADDLE NATURAL VESSEL CENTERLINES ON TANK.

3/16" THK. SHEET

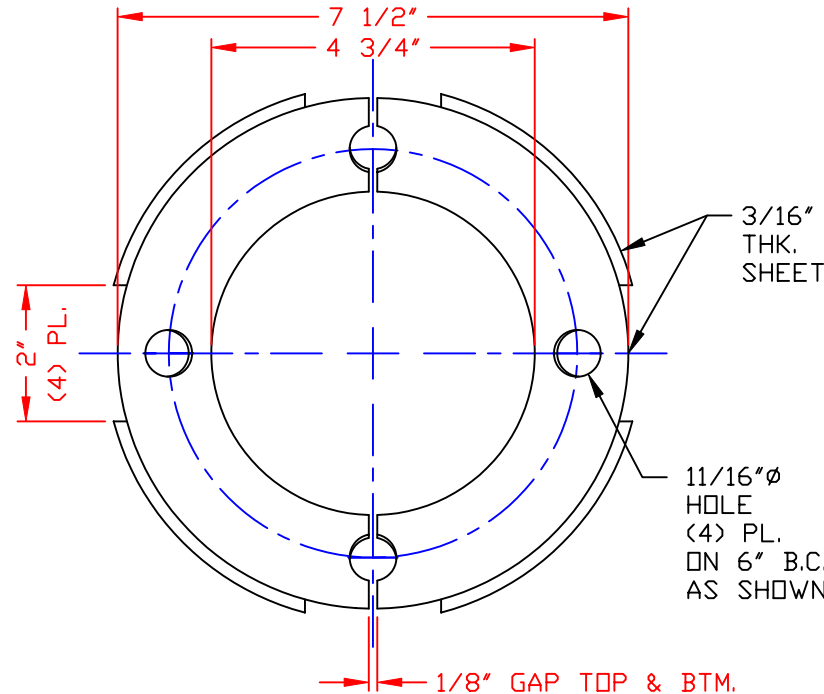
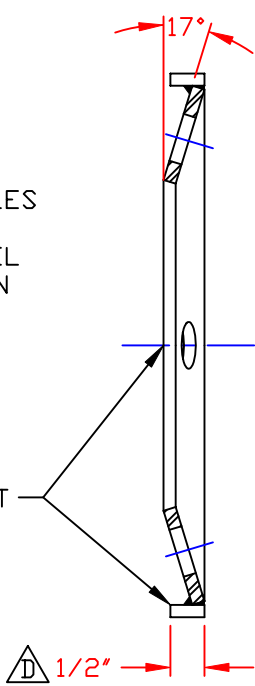

RING 3" SPLIT BACK-UP TAPERED

SCALE: 6"=1'-0"

A PPC ITEM NO. 4953 FOR SS 316L

B

NOTES

1. THIS IS A COMPUTER GENERATED DWG. DO NOT REVISE BY HAND.
2. COMPUTER DWG. NAME "TIMFOFTG."
3. IF NECESSARY, TIGHTEN THE BOLTS ON THE FTG. BY PULLING DOWN THE NUTS DIAMETRICALLY OPPOSITE EACH OTHER, IN SMALL INCREMENTS, USING A TORQUE WRENCH. TORQUE TO APPROX. 15/20 FT. LBS.

5/8"/SQUARE BEVEL WASHER/BLK PE (4) REQ'D.
 PPC ITEM NO. 5165 C

3"/FF FLG. GASKET/ EPDM, VITON XLPE, OR BUNA-N

1/2-13 BOLTS W/(2) WASHER W/LOCK WASHER W/1/2-13 NUT/ 316SS, ALLOY C-276, TITANIUM, OR MONEL (4) REQ'D.

DWG. TITLE		3"/TAPERED IMFO NOZZLE	
SCALE:	3"=1'-0"	POLY PROCESSING CO.	DR. D. RECTOR
DATE:	2-14-95		CK. K. HOBBS
SHEET:		DWG. NO.	REV.
1 OF 1		PPC021495-2	D